



£319,950 Guide Price

Woodmans Cottages, Knaresborough

Semi-Detached House | 2 Bedrooms | 1 Bathroom

01423 276100

N
NEWBY JAMES
Estate Agents

www.newbyjames.co.uk



Step Inside

Property Description

**** VIRTUAL 360 PROPERTY TOUR ****

A quintessential semi detached cottage with delightful gardens and detached garage situated within this sought after village of Flaxby.

Main Particulars

**** VIRTUAL 360 PROPERTY TOUR ****

A quintessential semi detached cottage with delightful gardens and detached garage situated within this sought after village of Flaxby. ******

This beautifully presented home is rich with rustic charm and character with sash windows, fireplaces and exposed wooden doors , boasting spacious accommodation throughout. The cottage exudes a cosy inviting atmosphere comprising in brief; entrance hall, lounge with wood burning stove, dining kitchen, rear hall with utility room/downstairs WC and access to the rear gardens.

To the first floor there are two good size bedrooms, the front bedroom having views over the village green, and a house bathroom with rolltop bath and separate shower enclosure.

The property is situated within this highly sought after semi rural village of Flaxby and is ideally placed for the commuter being within easy reach of the A1/M which gives direct access to Yorkshire's commercial centres and further afield. The property is well located for access to York, the nearby market town of Knaresborough and the spa town of Harrogate.

Tenure: Freehold



Approx Gross Internal Area
90 sq m / 964 sq ft

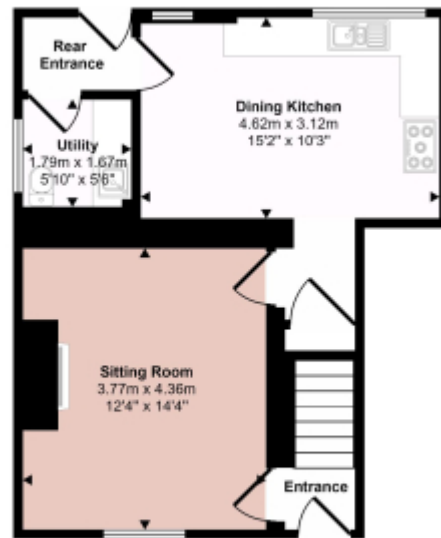

Ground Floor
Approx 45 sq m / 487 sq ft

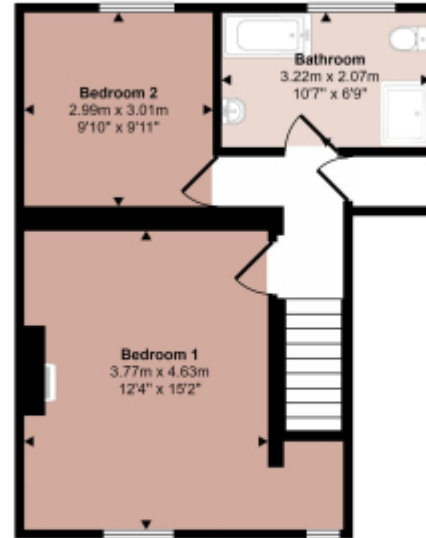

First Floor
Approx 44 sq m / 476 sq ft

This floorplan is only for illustrative purposes and is not to scale. Measurements of rooms, doors, windows, and any items are approximate and no responsibility is taken for any error, omission or mis-statement. Icons of items such as bathroom suites are representations only and may not look like the real items. Made with Made Snappy 360.

This floorplan is for illustrative purposes only and the location of doors, windows and other items are approximate.

Agents notes: All measurements are approximate and for general guidance only and whilst every attempt has been made to ensure accuracy, they must not be relied on. The fixtures, fittings and appliances referred to have not been tested and therefore no guarantee can be given that they are in working order. Internal photographs are reproduced for general information and it must not be inferred that any item shown is included with the property. Copyright © 2025 13566874 Registered Office: , 15 Market Place, Knaresborough, HG5 8AL

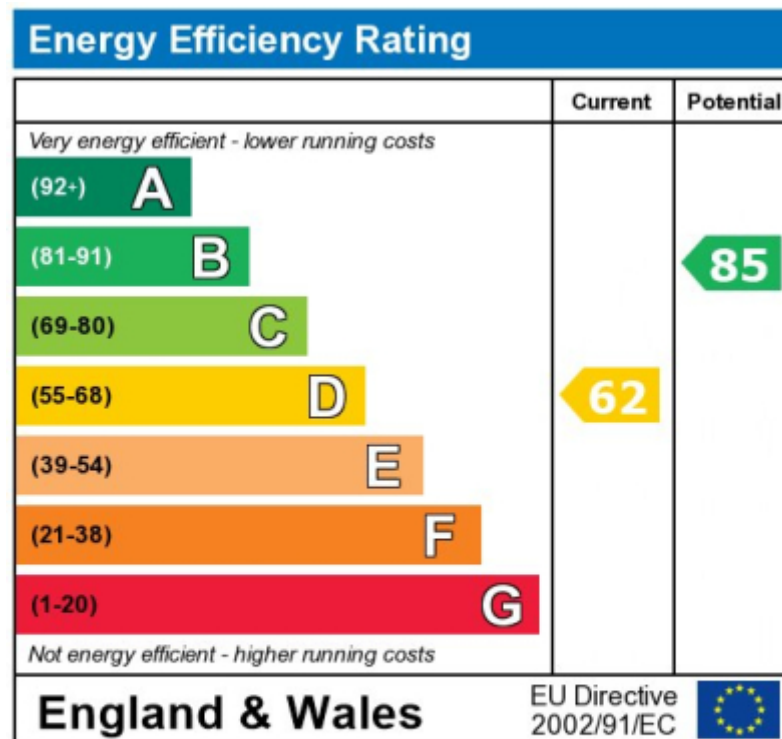

The energy efficiency rating is a measure of the overall efficiency of a home. The higher the rating the more energy

Telephone: 01423 276100

N
NEWBY JAMES
ESTATE AGENTS

www.newbyjames.co.uk